



## Part A

Premises licence number

001856

### Part 1 – Premises details

Postal address of premises, or if none, ordnance survey map reference or description

Havering Well  
148 Rush Green Road Romford RM7 0QA

Where the licence is time limited the dates

Not applicable

Licensable activities authorised by the licence

Films, indoor sporting events, live music, recorded music,  
performances of dance, late night refreshment, supply of alcohol

The times the licence authorises the carrying out of licensable activities

Films, indoor sporting events

Monday to Thursday – 10:00 to 23:00

Friday & Saturday – 10:00 to 00:00

Sunday – 10:00 to 23:00

Supply of alcohol

Monday to Thursday – 10:00 to 23:00

Friday & Saturday – 10:00 to 00:00

Sunday – 10:00 to 23:00

Good Friday – 10:00 to 00:00

Christmas Eve & New Year's Eve – 10:00 to 01:30

Live music, performances of dance

Monday to Thursday – 20:00 to 23:00

Friday & Saturday – 20:00 to 00:00

Sunday – 20:00 to 23:00

Recorded music

Monday to Thursday – 10:00 to 23:00

Friday & Saturday – 10:00 to 00:00

Sunday – 12:00 to 23:00

Late night refreshment

Friday & Saturday – 23:00 to 00:00

---

The opening hours of the premises

Sunday to Thursday – 10:00 to 23:30  
Friday & Saturday – 10:00 to 00:30  
Good Friday – 10:00 to 00:30  
Christmas Eve & New Year's Eve – 10:00 to 02:00

---

Where the licence authorises supplies of alcohol whether these are on and/ or off supplies

On and off supplies

---

Name, (registered) address, telephone number and email (where relevant) of holder of premises licence

Lloyd John Enterprises Ltd  
Havering Well 148 Rush Green Road Romford RM7 0QA  
01708 740249 / haveringwell@hotmail.com

---

Registered number of holder, for example company number, charity number (where applicable)

07095548

---

Name, address and telephone number of designated premises supervisor where the premises licence authorises for the supply of alcohol

Ms Joanna Black

---

Personal licence number and issuing authority of personal licence held by designated premises supervisor where the premises licence authorises for the supply of alcohol

----

---

Mandatory conditions

1. No supply of alcohol may be made under the premises licence:
  - (a) at a time when there is no designated premises supervisor in respect of the premises licence, or
  - (b) at a time when the designated premises supervisor does not hold a personal licence or his personal licence is suspended.
2. Every supply of alcohol under the premises licence must be made or authorised by a person who holds a personal licence.
3. (1) The responsible person must ensure that staff on relevant premises do not carry out, arrange or participate in any irresponsible promotions in relation to the premises.  
(2) In this paragraph, an irresponsible promotion means any one or more of the following activities, or substantially similar activities, carried on for the purpose of encouraging the sale or supply of alcohol for consumption on the premises—
  - (a) games or other activities which require or encourage, or are designed to require or encourage, individuals to—

---

**Mandatory conditions – contd.**

- (i) **drink a quantity of alcohol within a time limit (other than to drink alcohol sold or supplied on the premises before the cessation of the period in which the responsible person is authorised to sell or supply alcohol), or**
    - (ii) **drink as much alcohol as possible (whether within a time limit or otherwise);**
  - (b) provision of unlimited or unspecified quantities of alcohol free or for a fixed or discounted fee to the public or to a group defined by a particular characteristic in a manner which carries a significant risk of undermining a licensing objective;**
  - (c) provision of free or discounted alcohol or any other thing as a prize to encourage or reward the purchase and consumption of alcohol over a period of 24 hours or less in a manner which carries a significant risk of undermining a licensing objective;**
  - (d) selling or supplying alcohol in association with promotional posters or flyers on, or in the vicinity of, the premises which can reasonably be considered to condone, encourage or glamorise anti-social behaviour or to refer to the effects of drunkenness in any favourable manner;**
  - (e) dispensing alcohol directly by one person into the mouth of another (other than where that other person is unable to drink without assistance by reason of disability).**
- 4. The responsible person must ensure that free potable water is provided on request to customers where it is reasonably available.**
- 5. (1) The premises licence holder or club premises certificate holder must ensure that an age verification policy is adopted in respect of the premises in relation to the sale or supply of alcohol.**
- (2) The designated premises supervisor in relation to the premises licence must ensure that the supply of alcohol at the premises is carried on in accordance with the age verification policy.**
- (3) The policy must require individuals who appear to the responsible person to be under 18 years of age (or such older age as may be specified in the policy) to produce on request, before being served alcohol, identification bearing their photograph, date of birth and either—**
- (a) a holographic mark, or**
  - (b) an ultraviolet feature.**
- 6. The responsible person must ensure that—**
- (a) where any of the following alcoholic drinks is sold or supplied for consumption on the premises (other than alcoholic drinks sold or supplied having been made up in advance ready for sale or supply in a securely closed container) it is available to customers in the following measures—**
    - (i) beer or cider: ½ pint;**
    - (ii) gin, rum, vodka or whisky: 25 ml or 35 ml; and**
    - (iii) still wine in a glass: 125 ml;**
  - (b) these measures are displayed in a menu, price list or other printed material which is available to customers on the premises; and**

---

**Mandatory conditions – contd.**

- (c) where a customer does not in relation to a sale of alcohol specify the quantity of alcohol to be sold, the customer is made aware that these measures are available.
7. A relevant person shall ensure that no alcohol is sold or supplied for consumption on or off the premises for a price which is less than the permitted price.
8. For the purposes of the condition set out in paragraph 7 —
- (a) “duty” is to be construed in accordance with the Alcoholic Liquor Duties Act 1979;
- (b) “permitted price” is the price found by applying the formula —
- $$P=D+(D \times V)$$
- where —
- (i) P is the permitted price,
- (ii) D is the amount of duty chargeable in relation to the alcohol as if the duty were charged on the date of the sale or supply of the alcohol, and
- (iii) V is the rate of value added tax chargeable in relation to the alcohol as if the value added tax were charged on the date of the sale or supply of the alcohol;
- (c) “relevant person” means, in relation to premises in respect of which there is in force a premises licence —
- (i) the holder of the premises licence,
- (ii) the designated premises supervisor (if any) in respect of such a licence, or
- (iii) the personal licence holder who makes or authorises a supply of alcohol under such a licence;
- (d) “relevant person” means, in relation to premises in respect of which there is in force a club premises certificate, any member or officer of the club present on the premises in a capacity which enables the member or officer to prevent the supply in question; and
- (e) “value added tax” means value added tax charged in accordance with the Value Added Tax Act 1994.
9. Where the permitted price given by paragraph (b) of paragraph 8 would (apart from this paragraph) not be a whole number of pennies, the price given by that sub-paragraph shall be taken to be the price actually given by that sub-paragraph rounded up to the nearest penny.
10. (1) Sub-paragraph (2) applies where the permitted price given by paragraph (b) of paragraph 8 on a day (“the first day”) would be different from the permitted price on the next day (“the second day”) as a result of a change to the rate of duty or value added tax.
- (2) The permitted price which would apply on the first day applies to sales or supplies of alcohol which take place before the expiry of the period of 14 days beginning on the second day.
11. The admission of children, that is persons aged under 18, to the exhibition of any film shall be restricted in accordance with any recommendation made by the film classification body designated by section 4 of the Video Recordings Act 1984.
12. If at specified times one or more individuals must be at the premises to carry out a security activity each such individual must be licensed by the Security Industry Authority.

---

**Annex 2 – conditions consistent with the operating schedule**

- 1. Staff shall monitor customers' behaviour at all times.**
- 2. Fire equipment shall be checked and maintained regularly.**
- 3. External sound levels shall be inspected on a regular basis.**
- 4. Staff shall encourage customers to disperse in an orderly manner.**
- 5. Staff shall refuse to sell alcohol to anyone under the age of 18.**
- 6. Anyone under the age of 16 shall remain the responsibility of the accompanying adult when using the premises and/or exterior area.**
- 7. In addition to the use of temporary event notices allowed under the Licensing Act 2003 the premises may open on 12 non-standard occasions in line with the Association of Chief Police Officers guidelines subject to a minimum of 10 working days' notice being given to the Licensing Authority and the Police for each occasion. The prior written consent of the Police shall be obtained and the Police shall have an absolute right to refuse any occasion. A register shall be kept at the premises in the manner required by the Police and Licensing Authority and available for inspection by the Police or an authorised officer of the Licensing Authority and details of each occasion shall be recorded in it including the written consent of the Police.**
- 8. Alcohol shall not be sold or supplied unless it is paid for before or at the time when it is sold or supplied except alcohol sold or supplied:**
  - (a) with and for consumption at a meal supplied at the same time, consumed with the meal and paid for together with the meal;**
  - (b) for consumption by a person residing in the premises or his guest and paid for together with his accommodation;**
  - (c) to a canteen or mess.**
- 9. Alcohol shall not be sold or supplied except during permitted hours. In this condition permitted hours means:**
  - (a) on weekdays as stated above;**
  - (b) on Sundays as stated above;**
  - (c) on Good Friday as stated above;**
  - (d) on Christmas Day 12:00 to 15:00 & 19:00 to 22:30;**
  - (e) on New Year's Eve 10:00 to 01:30.**

**The above restrictions do not prohibit:**

  - (i) the consumption of the alcohol on the premises during the first twenty minutes after the above hours;**
  - (ii) the taking of the alcohol from the premises unless the alcohol is supplied or taken in an open vessel during the first thirty minutes after the above hours;**
  - (iii) the consumption of the alcohol on the premises by persons taking meals there during the first thirty minutes after the above hours if the alcohol was supplied for consumption ancillary to those meals;**
  - (iv) consumption of the alcohol on the premises by, or the taking, sale or supply of alcohol to, any person residing in the licensed premises;**
  - (v) the ordering of alcohol to be consumed off the premises or the despatch by the vendor of the alcohol so ordered;**

---

---

**Annex 2 – conditions consistent with the operating schedule – contd.**

- (vi) the sale of alcohol to a trader or club for the purposes of the trade or club;**
  - (vii) the sale or supply of alcohol to any canteen or mess being a canteen in which the sale or supply of alcohol is carried out under the authority of the Secretary of State or an authorised mess of members of Her Majesty's naval, military or air forces;**
  - (viii) the taking of alcohol from the premises by a person residing there;**
  - (ix) the supply of alcohol for consumption on the premises to any private friends of a person residing there who are bona fide entertained by him at his own expense or the consumption of alcohol by persons so supplied; or**
  - (x) the supply of alcohol for consumption on the premises to persons employed there for the purposes of the business carried on by the holder of the licence or the consumption of liquor so supplied if the liquor is supplied at the expense of their employer or of the person carrying on or in charge of the business on the premises.**
- 10. The external area shall always be staffed when it is open to the public. It shall be covered by CCTV and shall be constantly monitored by staff.**
  - 11. Fire equipment shall be installed, checked and maintained. CCTV shall be in place and staff shall constantly monitor it.**
  - 12. Staff shall discourage loudness.**
  - 13. External sound shall be inspected on a regular basis and turned off at the appropriate time.**
  - 14. The serving of food shall cease at 21:00 every day to prevent noise nuisance.**
  - 15. The external bar shall close at 23:00.**
  - 16. No amplified music or speech shall be played or reproduced in the external seating area at any time.**
  - 17. Anyone under the age of 16 years shall remain the responsibility of the accompanying adult when using the premises.**

---

---

**Annex 3 – conditions attached after a hearing by the Licensing Authority**

- 1. In conjunction with the Metropolitan Police a written drug and alcohol policy and a written child protection policy shall be developed.**

---

Annex 4 – premises plans

Original premises plans are held by the Licensing Authority of the London Borough of Havering.



ign  
161

Annex 4 – premises plans – contd.

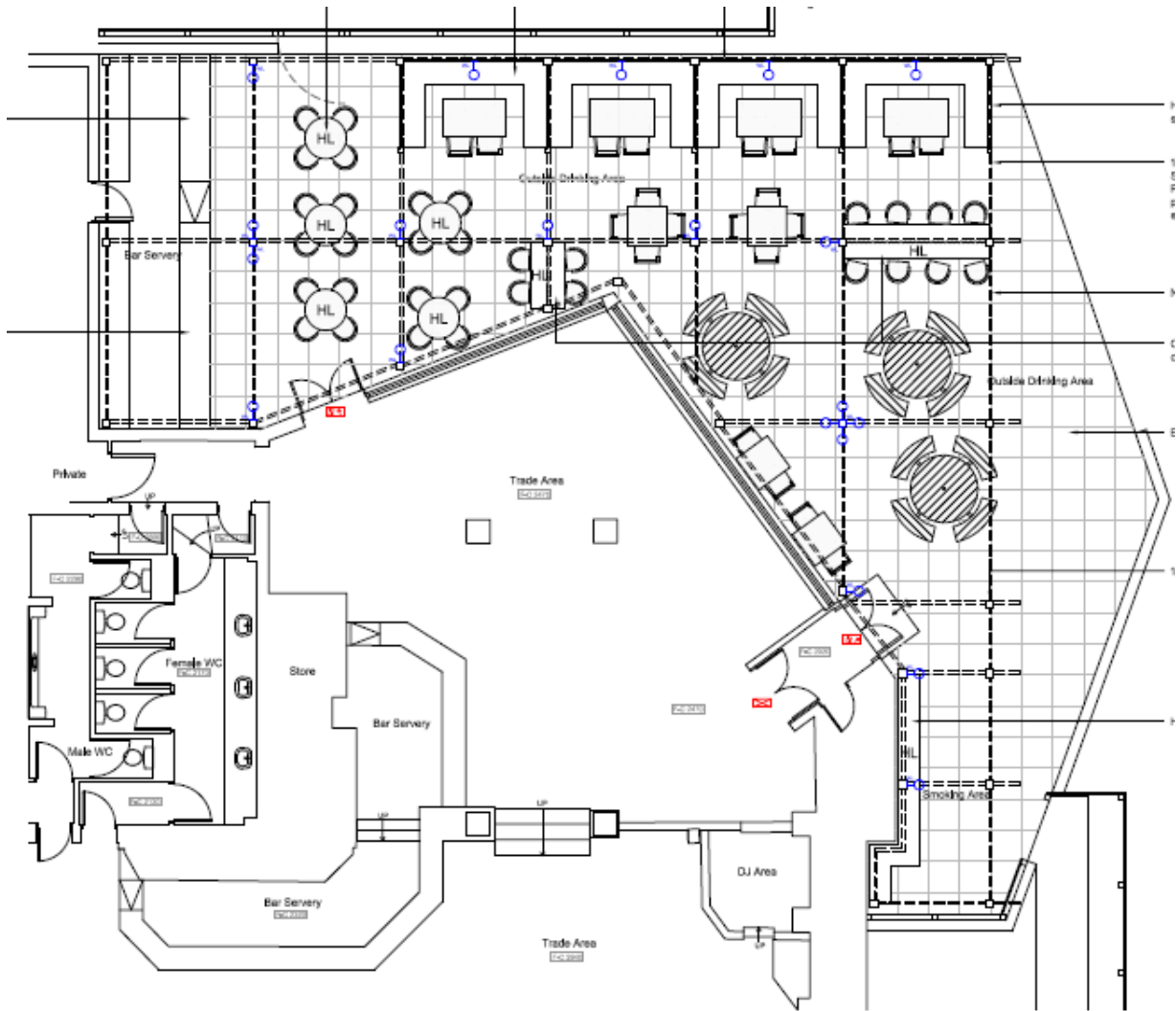





## Part B

### Premises licence summary

Premises licence number

001856

### Premises details

Postal address of premises, if any, or if none, ordnance survey map reference or description

Havering Well  
148 Rush Green Road Romford RM7 0QA

Where the licence is time limited the dates

Not applicable

Licensable activities authorised by the licence

Films, indoor sporting events, live music, recorded music,  
performances of dance, late night refreshment, supply of alcohol

The times the licence authorises the carrying out of licensable activities

#### Films, indoor sporting events

Monday to Thursday – 10:00 to 23:00

Friday & Saturday – 10:00 to 00:00

Sunday – 10:00 to 23:00

#### Supply of alcohol

Monday to Thursday – 10:00 to 23:00

Friday & Saturday – 10:00 to 00:00

Sunday – 10:00 to 23:00

Good Friday – 10:00 to 00:00

Christmas Eve & New Year's Eve – 10:00 to 01:30

#### Live music, performances of dance

Monday to Thursday – 20:00 to 23:00

Friday & Saturday – 20:00 to 00:00

Sunday – 20:00 to 23:00

#### Recorded music

Monday to Thursday – 10:00 to 23:00

Friday & Saturday – 10:00 to 00:00

Sunday – 12:00 to 23:00

---

---

The times the licence authorises the carrying out of licensable activities – contd.

**Late night refreshment  
Friday & Saturday – 23:00 to 00:00**

---

---

The opening hours of the premises

**Sunday to Thursday – 10:00 to 23:30  
Friday & Saturday – 10:00 to 00:30  
Good Friday – 10:00 to 00:30  
Christmas Eve & New Year's Eve – 10:00 to 02:00**

---

---

Where the licence authorises supplies of alcohol whether these are on and / or off supplies

**On and off supplies**

---

---

Name, (registered) address of holder of premises licence

**Lloyd John Enterprises Ltd  
Havering Well 148 Rush Green Road Romford RM7 0QA**

---

---

Registered number of holder, for example company number, charity number (where applicable)

**07095548**

---

---

Name of designated premises supervisor where the premises licence authorises for the supply of alcohol

**Ms Joanna Black**

---

---

State whether access to the premises by children is restricted or prohibited

**Restricted**

**2 of 2**

---

---